

DynamicHealth™

<https://www.dynahealth.com/skills/t915615-mask-goggle-and-face-shield-utilization>

Nursing Skills

Mask, Goggle, And Face Shield Utilization

Procedure

PROCEDURE STEPS

1. Position the mask to cover the nose and mouth

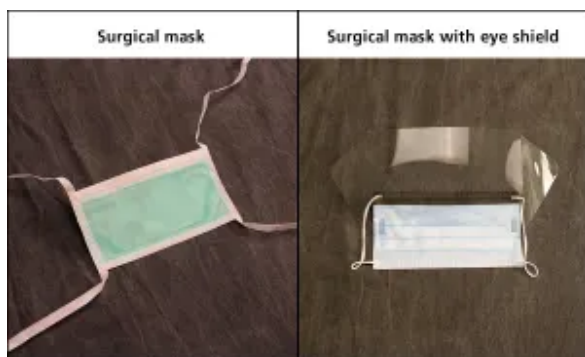

IMAGE 1

Surgical Masks With And Without Eye Protection

Copyright ©2016, EBSCO Information Services.



VIDEO 1

[Donning Personal Protective Equipment](#)

Steps 1-13.

Copyright ©2017, EBSCO Information Services.

2. Obtain goggles or face shield, mask, gloves, and other PPE from the appropriate storage location, as appropriate
3. Bring the mask over the face and tie the upper ties over the back of the head, if the mask has ties, making sure the end with the metal strip is placed over the nose⁶
4. Verify that the mask is covering the chin, and then tie the lower ties around the back of the neck⁶
5. If using a mask with ear loops, fit the loops around each ear to complete the process
6. Mold the nosepiece to the shape of your nose, using your fingertips⁶
7. Don eye protection or face shield⁶
8. Position the goggles over the eyes and place the strap across the back of the head

9. Verify that there is a tight seal around the eye area
10. Position the face shield so that it extends from the chin to the crown of the head and bring the tie over the head
11. Verify that the strap of the face shield is secure around the back of the head
12. When donning a face shield that is attached to a mask, position the mask snugly over the nose
13. Pull the lower section of the mask under the chin, and fasten the shield ties/straps around the head per manufacturer's instructions
14. Remove eye protection or face shield



VIDEO 2

[Removing \(Doffing\) Personal Protective Equipment](#)

Steps 14-17.

Copyright ©2017, EBSCO Information Services.

15. Do not touch the front surface as it is considered contaminated
16. Grasp the headband of the face shield/goggles around the back of the head and carefully pull up and over the head⁶
17. To remove eye protection or safety glasses, grasp the device over the ear pieces and remove carefully⁶
18. Discard disposable eye protection according to facility protocol
19. Place nondisposable eye protection in a designated receptacle for subsequent cleaning and disinfection
20. Clean and disinfect eye protection according to facility protocols
21. Rinse and allow to air dry. Wear gloves when cleaning and disinfecting eye protection devices
22. Reprocess contaminated eye protection devices in an area where other soiled equipment is handled
23. Remove the mask last by untying the ties or loops only⁶
24. Remove and discard the mask according to facility protocol as soon as is practical

Published by EBSCO Information Services. Copyright © 2020, EBSCO Information Services. All rights reserved. No part of this may be reproduced or utilized in any form or by any means, electronic or mechanical, including photocopying, recording, or by any information storage and retrieval system, without permission.

EBSCO Information Services accepts no liability for advice or information given herein or errors/omissions in the text. It is merely intended as a general informational overview of the subject for the healthcare professional.